

**SCHAEFER**

---

**600**





SCHAEFER

Symarine

660

770

SCHAEFER



## A N I N D U S T R Y L E A D E R

---

Schaefer Yachts is an industry leader in the design and construction of performance yachts between 30 and 83 feet. Boasting one of the biggest and most technologically advanced shipyards in South America, Schaefer Yachts has been transforming the marine industry for over 29 years. More than three thousand boats have been delivered worldwide. The shipyard has earned an exceptional reputation for setting high quality manufacturing standards with our proprietary and highly advanced production process. The shipyard's cutting-edge technology and eagle eye for details guarantee a vast range of vessels made with extreme precision. Schaefer Yachts is proud to be a shipyard that attends to the most demanding markets in the world.







**SCHAEFER**  
YACHTS





SCHAEFER



SCHAEFER

SCHAEFER

600











SCHAEFER

800

181  
Schaefer Yachts  
Lindenberg 1000 1000









SCHAEFER



















Raymarine







































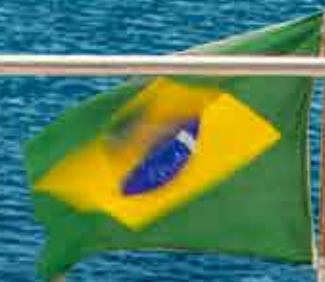

LATITUDE AZUL  
XXVII

LATITUDE AZUL  
XXVII









SCHAEFER



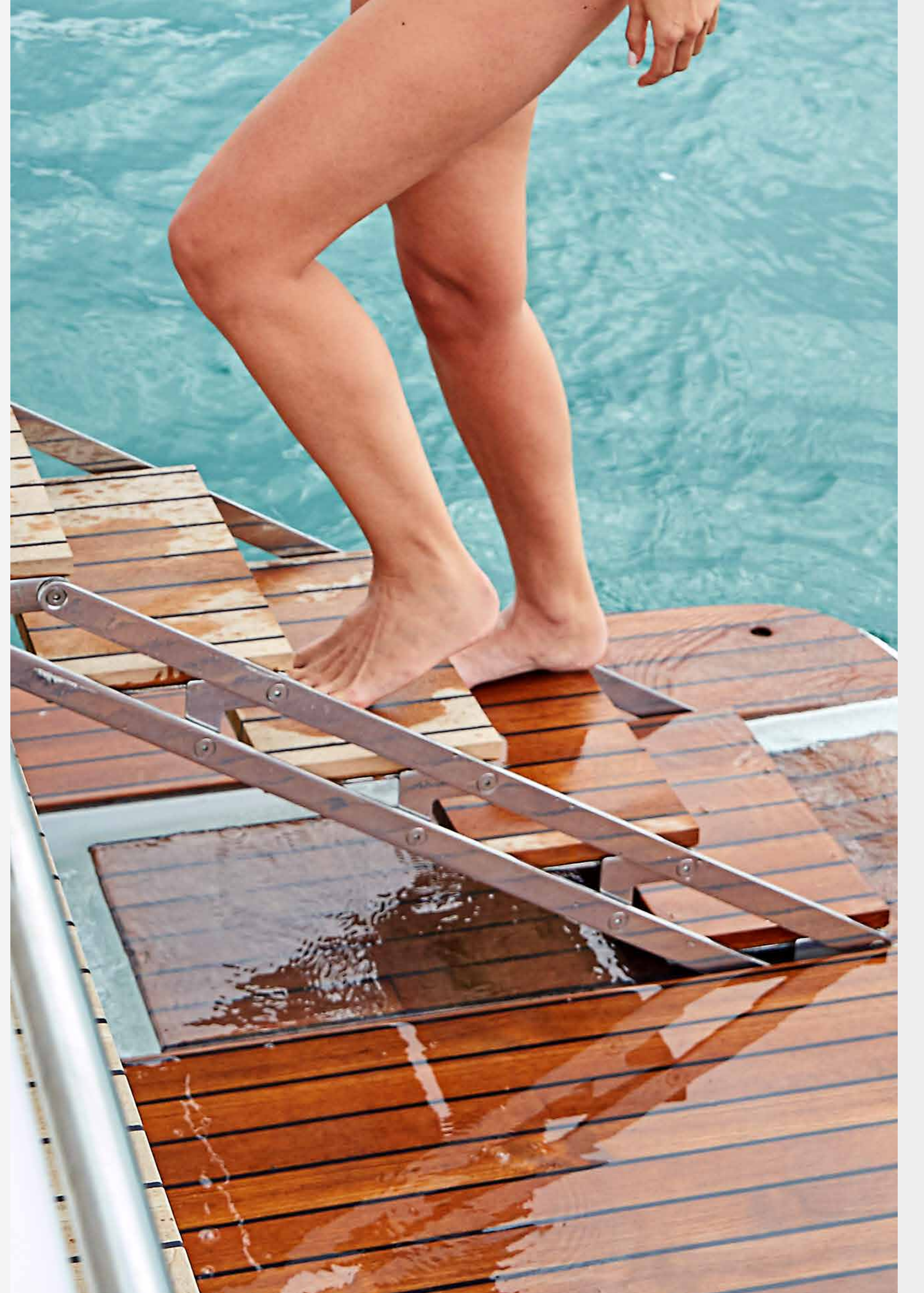



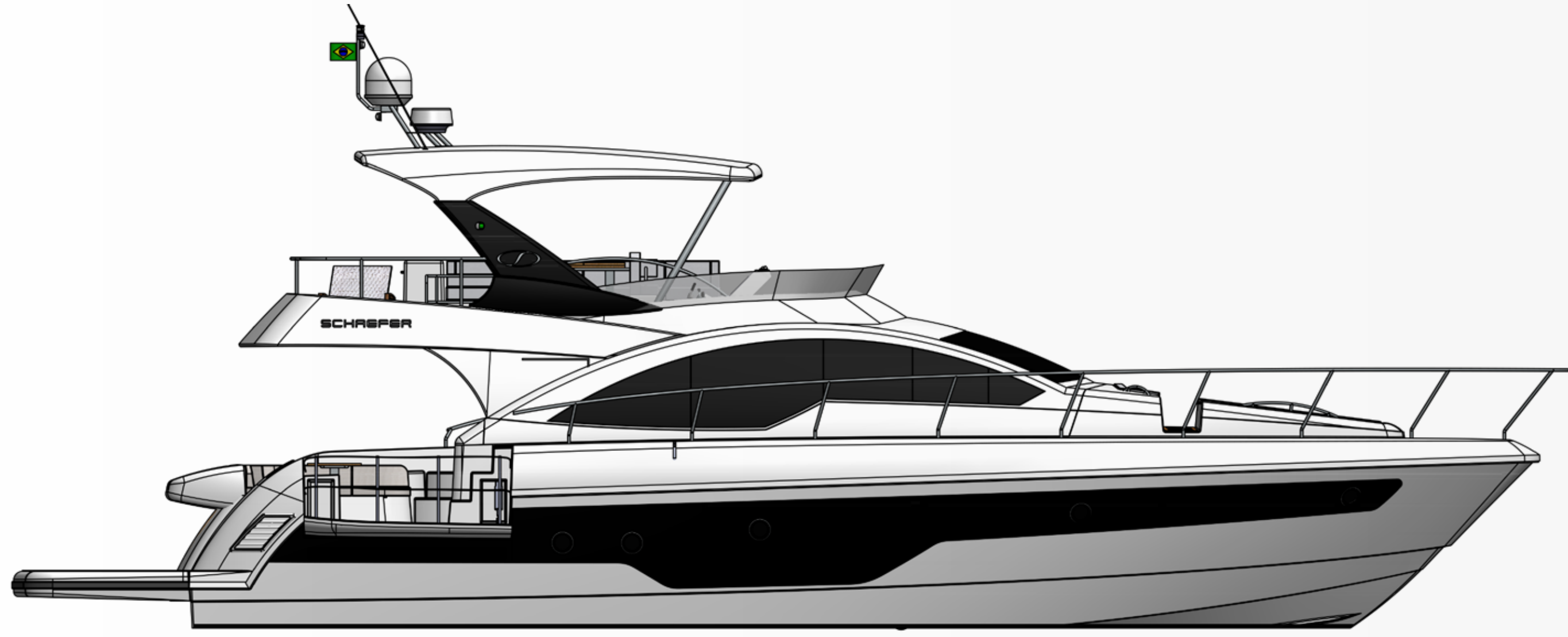

SCHAEFER  
600

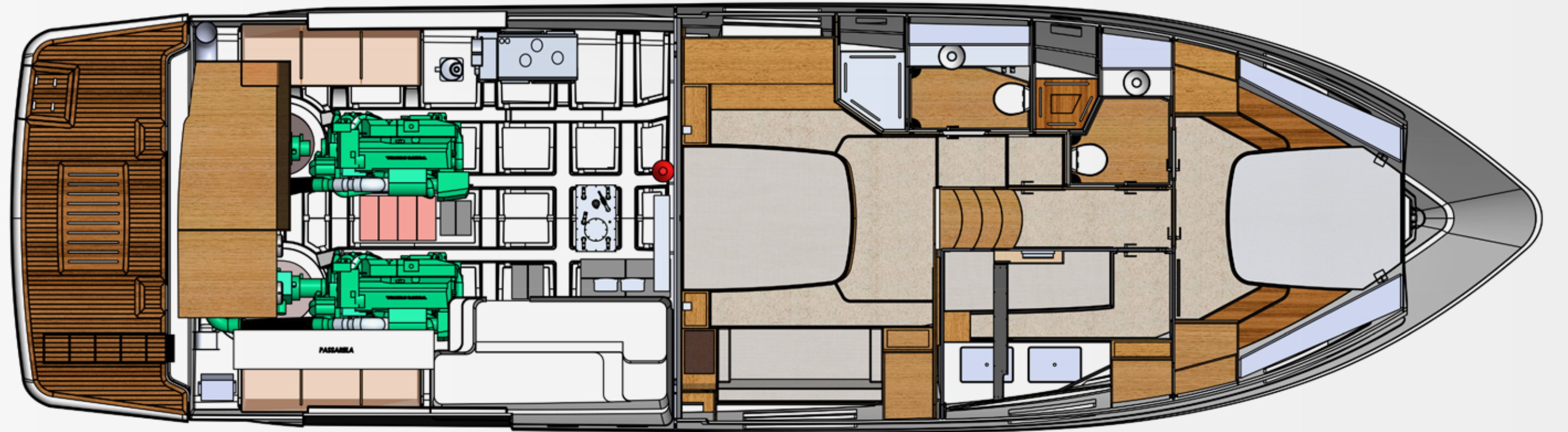
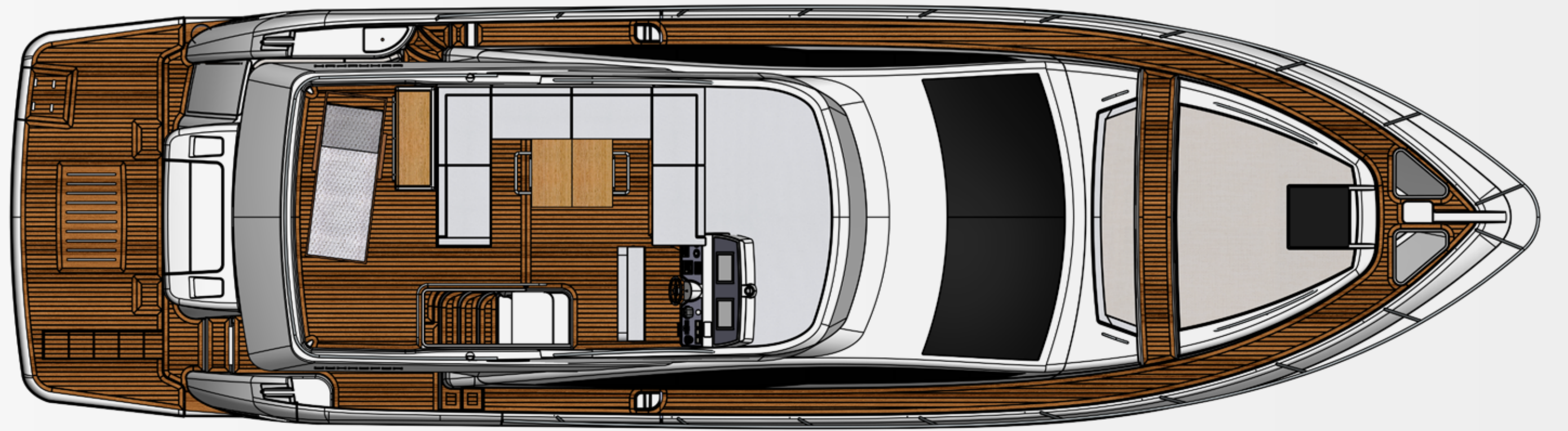





Max. length (including pulpit and platform): 18.08 m (59,.3')

Max beam (including guardrails): 4.96 m (16.3')

Max. draught: 1.45 m (4.8')

Light craft mass: 25,270 kg (55,710 lbs)

Deadrise angle: 14,1 °

Max. speed: 29 knots

Cruising speed\*: 24 knots

Fuel consumption at cruising speed: 182 L/h (48 gal/h)

Range: 189 N.M.

Fresh water capacity: 540 l (143 gal)

Fuel capacity: 2,100 l (555 gal)

Installed gensets: 1 x 17kW

Air draught: 6.87 m (22.5')

count extra 5' for clearance when passing under bridges.

Passenger capacity (day): 18

Passenger capacity (night): 6+2

Designer: Marcio Schaefer











V33 - 303 - 365 - 375 - 400 - 510  
FLY - 400 - 510 - 600 - 660 - 770 - 25M

*[schaeferyachts.com](http://schaeferyachts.com)*

